

# Area

AREA is a versatile projector that is ideal for spot lighting in commercial areas and exhibitions.

AREA has four optics which enable any project to be handled: intensive, medium, extensive and wallwasher.

This is a range of projectors to be installed in electrified track or ceiling surface mounted using an accessory.



Area

Installation	Electrified track
Diffuser	☼
Light source	LED
Photobiological safety	1
UGR	19
CRI	>80
MacAdam ellipse	3
Beam angle range	19-46
Power range (W)	25,5-51
Colour temperature (°K)	3000   4000
Light range	2580-5530
Power factor	0,9
Efficiency (%)	91,3
Expectancy	50000 h L70B10
DALI Option	✓
Continuous function 24h	✓
IP	20
Class	I

☼ PMMA lens



For other CRI values, please contact us.



# Area



**IP 20**    **CRI >80**    **UGR 19**    **19-46°**  
 Expectancy **50000 h.**    Efficiency (%) **91,3**  
 L70B10

Photobiological safety

RG0	Risk free
RG1*	Low risk
RG2	Moderate risk
RG3	High risk

\*Time under 3 h.

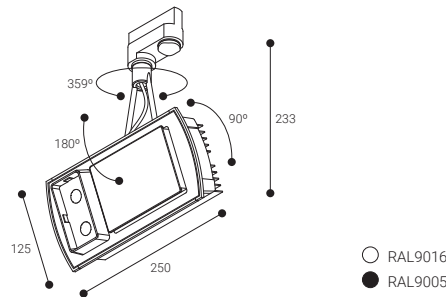

Intensive optics

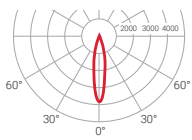

C0-C180    **η=85%**  
 C90-C270

Medium optics

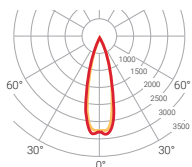

C0-C180    **η=91%**  
 C90-C270

Extensive optics

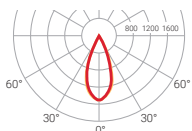

C0-C180    **η=83%**  
 C90-C270

Oval optics

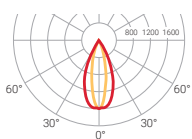

C0-C180    **η=73%**  
 C90-C270

	W	K	LUMEN	Beam angle	OPTICS	COLOUR	Beam diameter
<b>PAC33SB</b>	1x25,5W	3000	2580 lm	19°	Intensive	○	2,0
<b>PAC33SN</b>	1x25,5W	3000	2580 lm	19°	Intensive	●	2,0
<b>PAC33MB</b>	1x25,5W	3000	2580 lm	28°	Medium	○	2,0
<b>PAC33MN</b>	1x25,5W	3000	2580 lm	28°	Medium	●	2,0
<b>PAC33FB</b>	1x25,5W	3000	2580 lm	40°	Extensive	○	2,0
<b>PAC33FN</b>	1x25,5W	3000	2580 lm	40°	Extensive	●	2,0
<b>PAC33OB</b>	1x25,5W	3000	2580 lm	46°x24°	Oval	○	2,0
<b>PAC33ON</b>	1x25,5W	3000	2580 lm	46°x24°	Oval	●	2,0
<b>PAC34SB</b>	1x25,5W	4000	2765 lm	19°	Intensive	○	2,0
<b>PAC34SN</b>	1x25,5W	4000	2765 lm	19°	Intensive	●	2,0
<b>PAC34MB</b>	1x25,5W	4000	2765 lm	28°	Medium	○	2,0
<b>PAC34MN</b>	1x25,5W	4000	2765 lm	28°	Medium	●	2,0
<b>PAC34FB</b>	1x25,5W	4000	2765 lm	40°	Extensive	○	2,0
<b>PAC34FN</b>	1x25,5W	4000	2765 lm	40°	Extensive	●	2,0
<b>PAC34OB</b>	1x25,5W	4000	2765 lm	46°x24°	Oval	○	2,0
<b>PAC34ON</b>	1x25,5W	4000	2765 lm	46°x24°	Oval	●	2,0

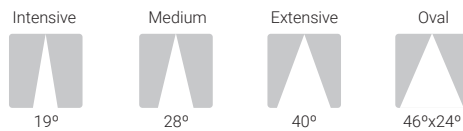

## Area

Compatible with **NormaLINK**

	W	K	LUMEN		OPTICS	COLOUR	
<b>PAC33DSB</b>	1x25,5W	3000	2580 lm	19°	Intensive	○	2,0
<b>PAC33DSN</b>	1x25,5W	3000	2580 lm	19°	Intensive	●	2,0
<b>PAC33DMB</b>	1x25,5W	3000	2580 lm	28°	Medium	○	2,0
<b>PAC33DMN</b>	1x25,5W	3000	2580 lm	28°	Medium	●	2,0
<b>PAC33DFB</b>	1x25,5W	3000	2580 lm	40°	Extensive	○	2,0
<b>PAC33DFN</b>	1x25,5W	3000	2580 lm	40°	Extensive	●	2,0
<b>PAC33DOB</b>	1x25,5W	3000	2580 lm	46°x24°	Oval	○	2,0
<b>PAC33DON</b>	1x25,5W	3000	2580 lm	46°x24°	Oval	●	2,0
<b>PAC34DSB</b>	1x25,5W	4000	2765 lm	19°	Intensive	○	2,0
<b>PAC34DSN</b>	1x25,5W	4000	2765 lm	19°	Intensive	●	2,0
<b>PAC34DMB</b>	1x25,5W	4000	2765 lm	28°	Medium	○	2,0
<b>PAC34DMN</b>	1x25,5W	4000	2765 lm	28°	Medium	●	2,0
<b>PAC34DFB</b>	1x25,5W	4000	2765 lm	40°	Extensive	○	2,0
<b>PAC34DFN</b>	1x25,5W	4000	2765 lm	40°	Extensive	●	2,0
<b>PAC34DOB</b>	1x25,5W	4000	2765 lm	46°x24°	Oval	○	2,0
<b>PAC34DON</b>	1x25,5W	4000	2765 lm	46°x24°	Oval	●	2,0



# Area

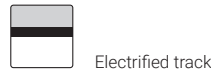

IP **20**      CRI **>80**      UGR **19**      **19-46°**

Expectancy **50000 h.**  
L70B10

Efficiency (%) **91,3**

Photobiological safety

RG0	Risk free
RG1*	Low risk
RG2	Moderate risk
RG3	High risk

\*Time under 3 h.

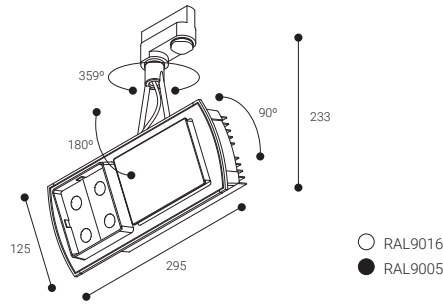

Intensive optics

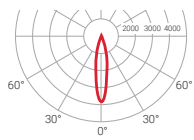

— C0-C180      **η=85%**  
— C90-C270

Medium optics

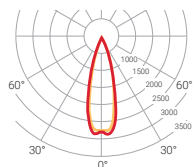

— C0-C180      **η=91%**  
— C90-C270

Extensive optics

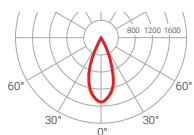

— C0-C180      **η=83%**  
— C90-C270

Oval optics

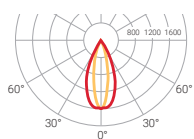

— C0-C180      **η=73%**  
— C90-C270

	W	K	LUMEN	Beam angle	OPTICS	COLOUR	Beam diameter
PAC53SB	1x51W	3000	5160 lm	19°	Intensive	○	3,0
PAC53SN	1x51W	3000	5160 lm	19°	Intensive	●	3,0
PAC53MB	1x51W	3000	5160 lm	28°	Medium	○	3,0
PAC53MN	1x51W	3000	5160 lm	28°	Medium	●	3,0
PAC53FB	1x51W	3000	5160 lm	40°	Extensive	○	3,0
PAC53FN	1x51W	3000	5160 lm	40°	Extensive	●	3,0
PAC53OB	1x51W	3000	5160 lm	46°x24°	Oval	○	3,0
PAC53ON	1x51W	3000	5160 lm	46°x24°	Oval	●	3,0
PAC54SB	1x51W	4000	5530 lm	19°	Intensive	○	3,0
PAC54SN	1x51W	4000	5530 lm	19°	Intensive	●	3,0
PAC54MB	1x51W	4000	5530 lm	28°	Medium	○	3,0
PAC54MN	1x51W	4000	5530 lm	28°	Medium	●	3,0
PAC54FB	1x51W	4000	5530 lm	40°	Extensive	○	3,0
PAC54FN	1x51W	4000	5530 lm	40°	Extensive	●	3,0
PAC54OB	1x51W	4000	5530 lm	46°x24°	Oval	○	3,0
PAC54ON	1x51W	4000	5530 lm	46°x24°	Oval	●	3,0

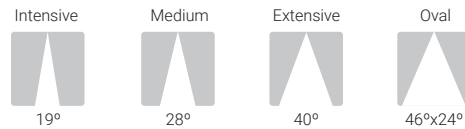

## Area

Compatible with **NormaLINK**

	W	K	LUMEN		OPTICS	COLOUR	
PAC53DSB	1x51W	3000	5160 lm	19°	Intensive	○	3,0
PAC53DSN	1x51W	3000	5160 lm	19°	Intensive	●	3,0
PAC53DMB	1x51W	3000	5160 lm	28°	Medium	○	3,0
PAC53DMN	1x51W	3000	5160 lm	28°	Medium	●	3,0
PAC53DFB	1x51W	3000	5160 lm	40°	Extensive	○	3,0
PAC53DFN	1x51W	3000	5160 lm	40°	Extensive	●	3,0
PAC53DOB	1x51W	3000	5160 lm	46°x24°	Oval	○	3,0
PAC53DON	1x51W	3000	5160 lm	46°x24°	Oval	●	3,0
PAC54DSB	1x51W	4000	5530 lm	19°	Intensive	○	3,0
PAC54DSN	1x51W	4000	5530 lm	19°	Intensive	●	3,0
PAC54DMB	1x51W	4000	5530 lm	28°	Medium	○	3,0
PAC54DMN	1x51W	4000	5530 lm	28°	Medium	●	3,0
PAC54DFB	1x51W	4000	5530 lm	40°	Extensive	○	3,0
PAC54DFN	1x51W	4000	5530 lm	40°	Extensive	●	3,0
PAC54DOB	1x51W	4000	5530 lm	46°x24°	Oval	○	3,0
PAC54DON	1x51W	4000	5530 lm	46°x24°	Oval	●	3,0

## ACCESSORIES

Ceiling mounted accessory

RAAB  
RAAN

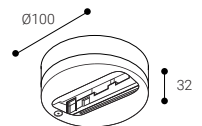

NOT COMPATIBLE WITH DALI FITTINGS